

## Facade anchor SDF-KB-10V

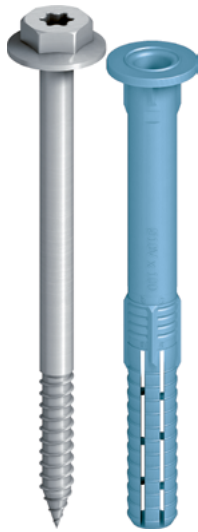

### Cross references

Cleaning brush  
 Blow-out pump  
 Tool belt  
 Corrosion protection spray  
 Hammer drill SDS plus  
 Cordless screwdriver ASCM  
 Cordless hammer drill  
 Bit hexabular TX30  
 Duster Expert SDS plus®

### Application range

- > Installation of metal attachments
- > For multiple fastening of non-load-bearing systems according to EAD 330284
- > Suitable for the structural fastening of wall cupboards, cladding, metal angle pieces
- > For application as single fastening in concrete

### Properties

- > Hexagon head with flange
- > When used according to ETAG 020, embedment depth in concrete can be reduced to 40 mm ( $h_{nom,1}$ )
- > Very short expansion part for extremely fast installation
- > Optimal expanding part due to radial expansion
- > Very high bending moment
- > Product identification through different sleeve colours
- > Double safety lock against torsion for secure installation

### Note

For planning and processing, please observe ETA-10/0305 and Z-21.2-2122. Further information about parameters and loads can be found in the approvals. For bricks of unknown quality, the load-bearing capacity must be determined through pull-out tests on the structure.

### Admissible loads

Tensile load  $N_{Rk,p}$  in concrete C12/15

Temperature range 30 °C / 50 °C	1.79kN
Temperature range 50 °C / 80 °C	1.59 kN

$F_{Rk}$  brick Mz 20-1.8, NF 0.71 kN

$F_{Rk}$  solid sand-lime brick KS 36, NF 1.14 kN

$F_{Rk}$  solid sand-lime brick KS 20, 8 DF 1.29 kN

Transverse load  $V_{Rk,s}$  at  $h_{nom,1} = 40$  mm

Steel screw ( $\gamma Ms = 1.25$ )	6.34 kN
Stainless steel screw ( $\gamma Ms = 1.56$ )	5.85 kN

Transverse load  $V_{Rk,s}$  at  $h_{nom,2} = 50$  mm

Steel screw ( $\gamma Ms = 1.25$ )	8.87 kN
Stainless steel screw ( $\gamma Ms = 1.56$ )	8.29 kN

Bending moment  $M_{Rk,s}$  at  $h_{nom,1} = 40$  mm

Steel screw ( $\gamma Ms = 1.25$ )	11.04 kN
Stainless steel screw ( $\gamma Ms = 1.56$ )	10.31 kN

Bending moment  $M_{Rk,s}$  at  $h_{nom,2} = 50$  mm

Steel screw ( $\gamma Ms = 1.25$ )	18.41 Nm
Stainless steel screw ( $\gamma Ms = 1.56$ )	17.06 kN

### Applications

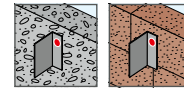

### Technical specifications

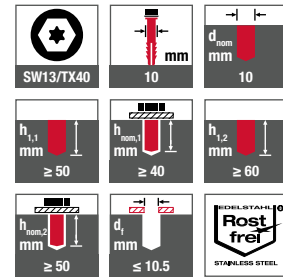

### Certifications

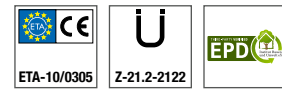

### Base materials

Approved for

- > Cracked concrete
- > Non-cracked concrete
- > Solid masonry
- > Hollow and perforated bricks

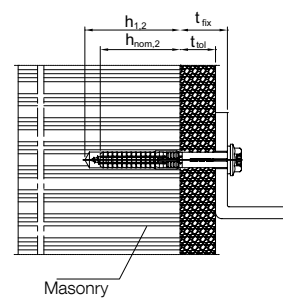
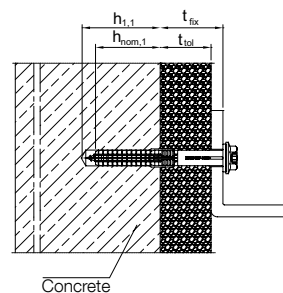



## Product online



Order description	Length [mm]	Fastening thickness $t_{fix}$ (concrete* / masonry) ≤ [mm]	PU [pieces]	Price/100 [EUR]	Article number	EAN
<b>Anchors with steel screws with zinc-plated Cr(VI)-free coating (-V)</b>						
SDF-KB-10Vx50-V	50	10 / -	100		8581050450	4061245018829
SDF-KB-10Vx60-V	60	20 / 10	100		8581060450	4061245018805
SDF-KB-10Vx70-V	70	30 / 20	100		8581070450	4061245018775
SDF-KB-10Vx80-V	80	40 / 30	100		8581080450	4061245018751
SDF-KB-10Vx100-V	100	60 / 50	50		8581100450	4061245018744
SDF-KB-10Vx120-V	120	80 / 70	50		8581120450	4061245018737
<b>Anchors with A4 stainless steel screws (-E)</b>						
SDF-KB-10Vx50-E	50	10 / -	100		8581050650	4061245018812
SDF-KB-10Vx60-E	60	20 / 10	100		8581060650	4061245018799
SDF-KB-10Vx70-E	70	30 / 20	100		8581070650	4061245018768
<b>*When using <math>h_{nom,1}</math> according ETAG 020</b>						

Further lengths  
available upon request

