

## Facade anchor SDF-S-10V

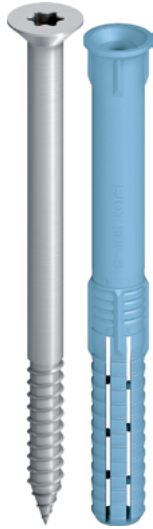

### Cross references

Cleaning brush  
 Blow-out pump  
 Tool belt  
 Corrosion protection spray  
 Hammer drill SDS plus  
 Cordless screwdriver ASCM  
 Cordless hammer drill  
 Bit hexabular TX40  
 Duster Expert SDS plus®

### Application range

- > Installation of timber or metal attachments
- > For multiple fastening of non-load-bearing systems according to EAD 330284
- > Suitable for the structural fastening of gates, doors, windows, square timber
- > For application as single fastening in concrete

### Properties

- > Countersunk head
- > When used according to ETAG 020, embedment depth in concrete can be reduced to 40 mm ( $h_{nom,1}$ )
- > Very short expansion part for extremely fast installation
- > Optimal expanding part due to radial expansion
- > Very high bending moment
- > Product identification through different sleeve colours
- > Double safety lock against torsion for secure installation

### Note

For planning and processing, please observe ETA-10/0305 and Z-21.2-2122. Further information about parameters and loads can be found in the approvals. For bricks of unknown quality, the load-bearing capacity must be determined through pull-out tests on the structure.

### Admissible loads

Tensile load  $N_{Rk,p}$  in concrete C12/15

Temperature range 30 °C / 50 °C	1.79kN
Temperature range 50 °C / 80 °C	1.59 kN
$F_{Rk}$ brick Mz 20-1.8, NF	0.71 kN
$F_{Rk}$ solid sand-lime brick KS 36, NF	1.14 kN
$F_{Rk}$ solid sand-lime brick KS 20, 8 DF	1.29 kN
Transverse load $V_{Rk,s}$ at $h_{nom,1} = 40$ mm	
Steel screw ( $\gamma Ms = 1.25$ )	6.34 kN
Transverse load $V_{Rk,s}$ at $h_{nom,2} = 50$ mm	
Steel screw ( $\gamma Ms = 1.25$ )	8.87 kN
Bending moment $M_{Rk,s}$ at $h_{nom,1} = 40$ mm	
Steel screw ( $\gamma Ms = 1.25$ )	11.04 kN
Bending moment $M_{Rk,s}$ at $h_{nom,2} = 50$ mm	
Steel screw ( $\gamma Ms = 1.25$ )	18.41 Nm

### Applications

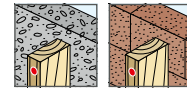

### Technical specifications

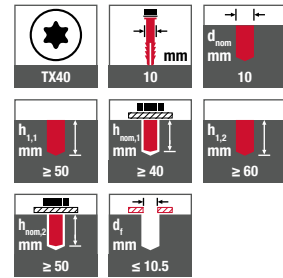

### Certifications

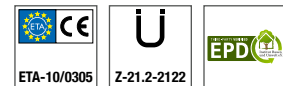

### Base materials

- Approved for
- > Cracked concrete
  - > Non-cracked concrete
  - > Solid masonry
  - > Hollow and perforated bricks

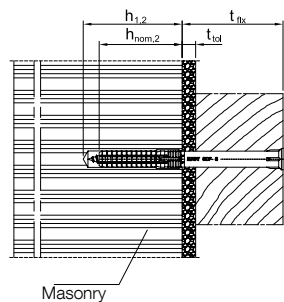
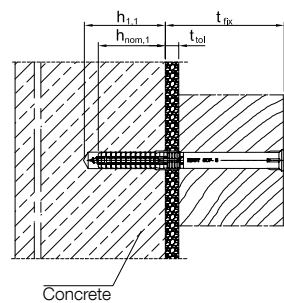



Product online



Order description	Length [mm]	Fastening thickness $t_{fix}$ (concrete* / masonry) ≤ [mm]	PU [pieces]	Price/100 [EUR]	Article number	EAN
<b>Anchors with steel screws with zinc-plated Cr(VI)-free coating (-V)</b>						
SDF-S-10Vx60-V	60	20 / 10	100		8580060450	4061245018928
SDF-S-10Vx70-V	70	30 / 20	100		8580070450	4061245018911
SDF-S-10Vx80-V	80	40 / 30	100		8580080450	4061245082998
SDF-S-10Vx100-V	100	60 / 50	50		8580100450	4061245018898
SDF-S-10Vx120-V	120	80 / 70	50		8580120450	4061245018881
SDF-S-10Vx140-V	140	100 / 90	50		8580140450	4061245018874
SDF-S-10Vx160-V	160	120 / 110	50		8580160450	4061245018867
SDF-S-10Vx180-V	180	140 / 130	50		8580180450	4061245018850
*When using $h_{nom,1}$ according ETAG 020						

Further lengths available upon request

